

ARE ADDITIONAL SECONDARY OPERATIONS CAUSING YOU TO LOSE WORK TO OFFSHORE COMPANIES?

GRIPflow can improve upon progressive die technology to produce stampings that look like they are machined and reduce your part costs!

Parts can be squeezed, coined, pierced, and blanked within the original strip of material allowing the part to be made to the drawing details.

Holes and the part edges have smooth, straight sides throughout the entire part thickness providing excellent bearing surfaces and part function. Tolerances of $\pm 0.001''$ can be achieved with the GRIPflow Stampings.

www.ebway.com

For more information on GRIPflow contact us — it could be the most profitable thing you do today!

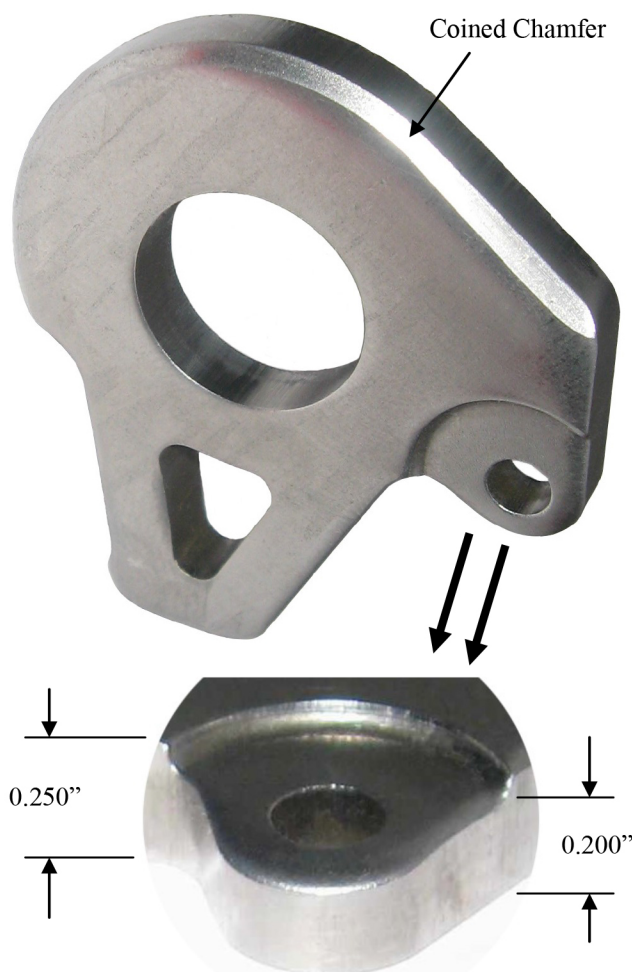

Coined features on this part eliminated secondary machining operations.



EBWAY

6600 N.W. 21 Avenue
Fort Lauderdale, FL 33309

Tel.: 954-971-4911

Fax: 954-971-5516

Email: ebway@ebway.com